

<b>Product Data Sheet</b>	<b>G12MF, MM, FM Type 2 Valve Manifold</b>
---------------------------	--

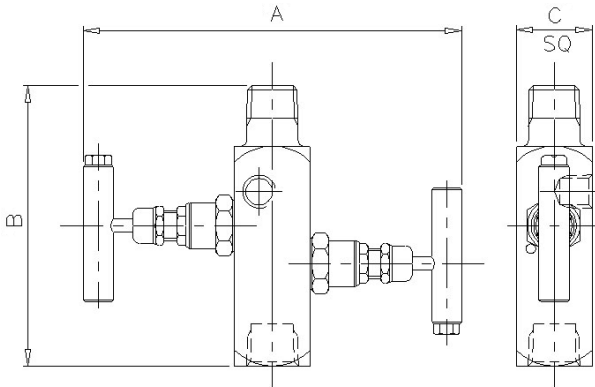

The 'G12' Type 2 valve manifold is designed for remote mounting to static pressure transmitters. The separate vent valve gives full control of venting of the instrument, plus the ability to calibrate in-situ. Each needle valve head is designed for safe and reliable isolation, giving bubble tight shut off, with non-rotating & anti-galling tip and dynamic self-adjusting spindle seal to give long service life in a variety of service conditions.

Part No.	Connections Size	A	B	C	Weight (Kgs)
G12MF	½" M x F	6.3	4.6	1.3	0.9
G12MM	½" M x M	6.3	5.4	1.3	0.9
G12FM	½" F x M	6.3	4.6	1.3	0.9

## Key Features of the Oliver Needle Valve range

- Non rotating tip - self centering & anti-galling
- Piston ring - gives dynamic adjustment of gland seal in response to pressure change
- Anti-blow out spindle - a major safety feature
- Secure seal - precision machined to give leak free operation for the life of the valve. Available in either PTFE or Grafoil

## Standard Specification

Pressure: 6000psi	Packing: PTFE	Handle: T-Bar	Bore: 0.21" (5.4mm)
Temp: 240 deg C	Thread form: NPT	Seat: Metal to metal	CV: 0.46
1/2" Inlet / Outlet Connections		1/4" NPT Vent Connection	

## Ordering Code

(Typical example) →	<b>G12MF</b>	<b>S</b>	/	<b>BT</b>	/	<b>AT</b>
<b>Type</b>						
G12MF - Male x Female G12MM - Male x Male G12FM - Female x Male						
<b>Material</b>						
S - 316S31 Stainless Steel M - Monel (400)						
HC - Hastalloy (C276) (Others available)						
<b>Optional Connections (NPT Standard)</b>						
BT - BSP Taper BP - BSP Parallel (top sealing) BTV - BSP Taper Vent						
BPV - BSP Parallel Vent BW-SCH*** - Butt weld (Schedule ***) MSW - Male Socket Weld						
<b>Options</b>						

AG - Grafoil  
AT - Anti-Tamper  
BKTC - Carbon steel mounting bracket  
BKTS - Stainless steel mounting bracket  
HL - Handle Locking  
HL-PI - Handle Locking + Position Indicator  
HW - Hand Wheel  
LT100 - Cryogenic Head Unit (-100°C)

MT - Metering Tip  
MTG - Tapped Mounting Holes x 2  
NA - NACE MR-01-75 (latest revision)  
OXY - Oxygen Cleaned  
PK - PEEK Soft Tip  
PP - Blank Plug In Vent Connection  
2H - Straight through mounting holes x 2