

PPH PUMP



Applications:

- Chemical applications,
- Medical applications,
- Welding machines,
- Chiller applications,
- Air conditioning systems,

Fluid Specifications:

- Coolants,
- Cutting oils,
- Water,
- Chemical liquids,
- Fluid temperature 0...60 °C
- Kinematic viscosity 1...12 mm²/s

Materials:

Pump body	: PPS
Motor Flange	: PPS
Impeller	: PEEK
Pump Shaft	: AISI 316
Circlip, key	: AISI 316
O-ring	: C-SiC-SS316-Viton

Electric motor	: 3 phase induction motor 1 phase induction motor (Optional) 2 pole Protection degree IP 54
----------------	--

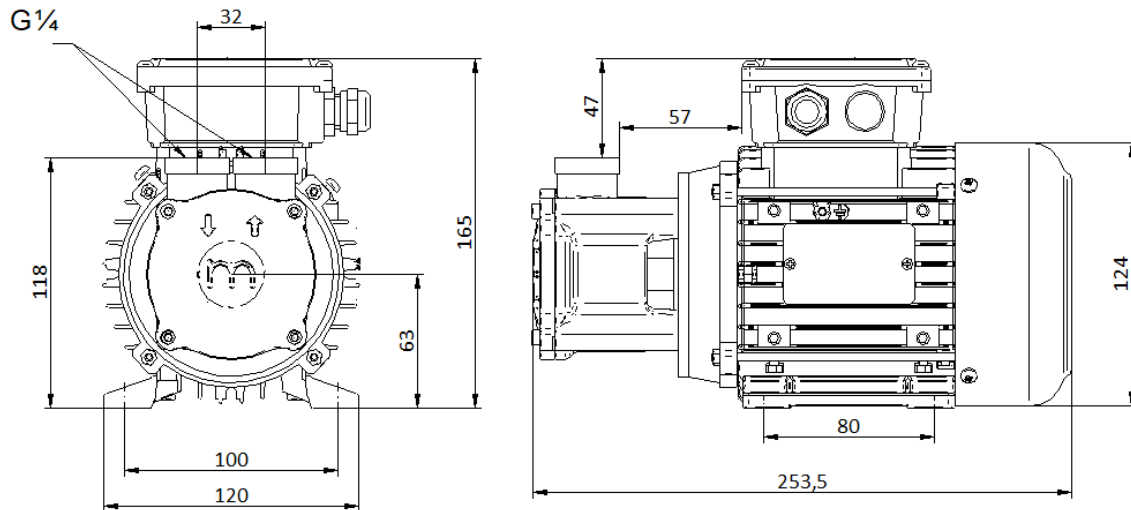

DIMENSIONS & NOMINAL VALUES

	Weight	Power	Voltage	Frequency	Rated current	Speed
TYPE	kg	kW	V(ΔY)	Hz	A	rpm
PPH 1125	5,5	0.25	230/400	50	1,26/0,73	2760
PPH 1137	5,9	0.37	230/400	50	2,16/1,25	2820

* The performance curves are based on 1 mm²/s (cSt) kinematic viscosity values and 997 kg/m³ density
 ** Curve tolerance according to ISO 9906:2012 Grade 3B.

Performance Curve

