

GEVA 80 Pilot Operated 1/4", 3/8", 1/2", 3/4", 1" 2/2 Way NC, NO

General Description

Geva 80 pilot operated 2/2 way NC, NO solenoid valves are recommended for applications where high flow at high pressure is required. They can be used in control and automation systems.

The modular concept of the valve allows many combinations and variations to meet different requirements and fluid compatibility.

The typical applications are: process systems, industrial furnace, water or sewage treatment, heating equipment, burners, oil and gas, autoclaves, dental equipment, instrumentation, car washers, machine industries and irrigation.



Notes

- The working pressure is 12 bar. For nylon, only 10 bar.
- A minimum differential pressure of 0.3 to 0.5 bar is required.
- To order valves manufactured to your specific requirements, please contact our technical sales department.
- Plastic valves are available in 3/8" and 1/2".
- Options:
 - Low power coils
 - Explosion-proof coils
 - A slow closing system to prevent a water hammer effect.

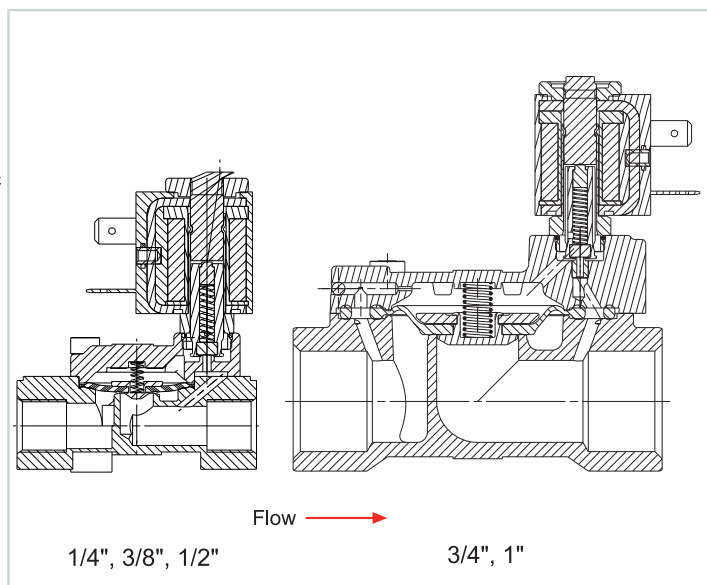

How to Order

Example : G80-S-2201V0-321

Is a GEVA 80 pilot operated valve, Brass, 1/4" BSP, 2WNC, Viton seals, without manual override, 24V AC 6W 60Hz, with connector.

Note: When ordering without coil, please define what current and pressure rating is needed (DC, AC).

G80-S	Body ⁽¹⁾	Port	Function	Seals	Manual Override	Voltage	Power	Connector
	Brass (2) 2	1/4" BSP 20	2W NC 1	NBR N	None 0	W/out coil 0	No coil 0	without 0
	Nylon (2) 4	1/4" NPT 21	2W NO 2	Viton V		6 1	AC7.5W50Hz 1	with 1
		3/8" BSP 30		EPDM E		12 2	AC6W60Hz 2	with bi-color 2
		3/8" NPT 31		Kalrez K		24 3	DC6.5W 3	LED 3
		1/2" BSP 40				110 5	AC4W50Hz 4	with LED and surge protection 3
		1/2" NPT 41				230 7	AC3W60Hz 5	other 9
		3/4" BSP 50				other 9	DC3W 7	
		3/4" NPT 51						
		1" BSP 60						
		1" NPT 61						

(1) For St.st tube add "s"

(2) 3/8" & 1/2" only



Technical Specifications

Function: 2/2 Way NC, NO
 Ports size: 1/4", 3/8", 1/2", 3/4", 1" BSP & NPT
 Pressure and flow: See table
 Temperature range: Fluid: max 80° C
 Ambient: -10° C to 50° C

Materials in contact with fluid :

Main valve :

Brass - hot stamping, upon request dezinc brass (Cz132) or Nylon 66

Solenoid operator:

Brass and Stainless steel 400 series

Seals: NBR, Viton, EPDM, Kalrez

Electrical specifications

Standard voltages: 24, 110, 230V AC 6, 12, 24V DC
 Duty cycle: 100%
 Variation in voltage: ±10% nominal voltage

Protection class IP65 with connector

Pressure and flow table

Size	Orifice (mm)	Pressure	Kv (L/Min)
1/4"	8	0.5-10	12
3/8"	8		16
1/2"	12		35

Valve Specification NC Type

Port Connection	Orifice (mm)	Kv (L/min)	Pressure Range		Weight (gf) *less coil
			AC	DC	
3/4"	20	130	0,3-12	0,3-12	690
1"	25	200	0,5-12	0,5-12	980

Valve Specification NO Type

Port Connection	Orifice (mm)	Kv (L/min)	Pressure Range		Weight (gf) *less coil
			AC	DC	
3/4"	20	130	0,3-10	0,3-10	690
1"	25	200	0,5-10	0,5-10	980

* Coil weight approx.110(gf), connector approx.25(gf)

Size	A	B	C	D	E	F	G	H	J	K
1/4"-3/8"	58	86	22	32	65	1/4"-3/8"BSP/NPT	125	11	M5X0.8	22
1/2"	70	90	27	38	68	1/2" BSP/NPT	135	13.5	M5X0.8*	22*

Dimensions

* Not available in plastic

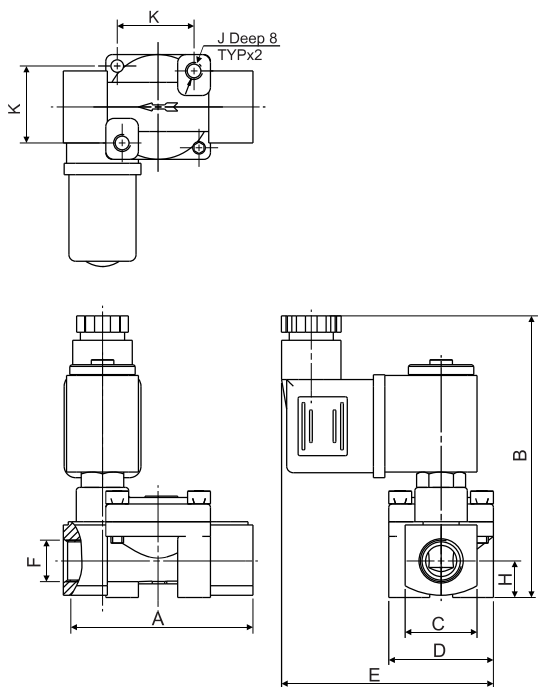

Port Size	A	B	C	D	F	H	L	I	J
3/4"BSP/NPT	90	96.3	32	55	3/4"	17	15	25	103
1" BSP/NPT	100	102.8	38.5	65	1"	21	16	29.5	109.50

