

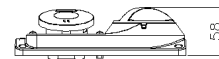

**SERIES PRIMA
INTERLOCKED SOCKET**
CODE 493124

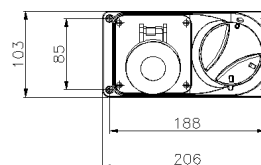

Datasheet

Electrical characteristics

Rated current	16A
Supply Voltage	110V 50/60Hz ●
Poles	2P+ $\frac{1}{2}$
Clock Position	4h
Rated insulation voltage	690V
Insulation Class	II
Protection	-
Signal plug inserted	-

Mechanical characteristics

Manufacturing material	Recyclable technopolymer
Treatment type	-
Surface finishing	-
Color	Grey RAL 7035
Width	103 mm
Execution	Board
Hole type	-
Protection degree	IP44
Additional degree protection	-
Shock resistance	IK08 according to IEC/EN 62262
Resistance to Glow wire	650°C
Flame rating according UL94	HB
Corrosivity category	-
Net Weight	0.48 KG
Working Environment Temp.	Min: -25°C ;Max: +50°C
Warehousing Temperature	Min: -30°C ;Max: +70°C

Technical data switch

Thermal current	16 A
Rated short-circuit current	10 kA
Terminals type	Screw - indirect clamping
Conductors section	Min: 1 mm ² ;Max: 10 mm ²
Terminal tightening torque	2 Nm
Auxiliary status contacts	-
Padlockable handle	1 lock Ø3 mm max

Operating category

Categoria Rating	Tensione Voltage	Corrente / Potenza Current / Power
AC-22A	230 V	16 A
	400 V	16 A
	500 V	16 A
	690 V	16 A
AC-23A	230 V	16 A
	400 V	16 A
	500 V	16 A
	690 V	16 A
AC-23A / AC-3	230 V	5.1 kW
	400 V	8.9 kW
	500 V	11.1 kW
	690 V	15.3 kW

Reference Standards and Directives

Certification and approval marks CE, UKCA

Directives 2011/65/EU (RoHS), 2014/35/EU (LVD), 2012/19/EU (WEEE)

Reference Standards EN 60309-1:1999, EN 60309-4:2007, EN 60309-1:1999/A1:2007, EN 60309 1:1999/A2:2012, EN 60309 1:1999/A1AC:2014, EN 60309 4:2007/A1:2012, EN 60309-2:1999, EN 60309 2:1999/A1:2007, EN 60309-2:1999/A2:2012, EN 63000:2018

The images are purely indicative. Palazzoli reserves the right to make changes without notice.