

REVISION HISTORY				
ZONE	REV	DESCRIPTION	DATE	APPROVED
RIGHT SIDE	1	HOLE POWER INLET	2/3/2017	P CH
RIGHT SIDE	2	HOLE FOR CONTROL PANEL	8/25/2017	P CH
TOP COVER	3	NEW AIRFLOW HOLES	9/11/2018	P CH

- NOTES:
 1.0 CUSTOMER:
 2.0 SUMIT DRAWING FOR APPROVAL.
 3.0 CONSTRUCTION:
 3.1 BODY BUILD IN WELDED PP 3/8".
 3.2 FRONT METAL DOOR WITH TEMPERED GLASS.
 4.0 REMOVABLE POLYPRO SHELVES IQUAL SPACING BETWEEN SHELVES.
 5.0 POWER INLET 120 V 60 HZ
 6.0 FSA ALARM SYSTEM.
 7.0 STANDARD FEATURES APPLIED.
 8.0 W/O

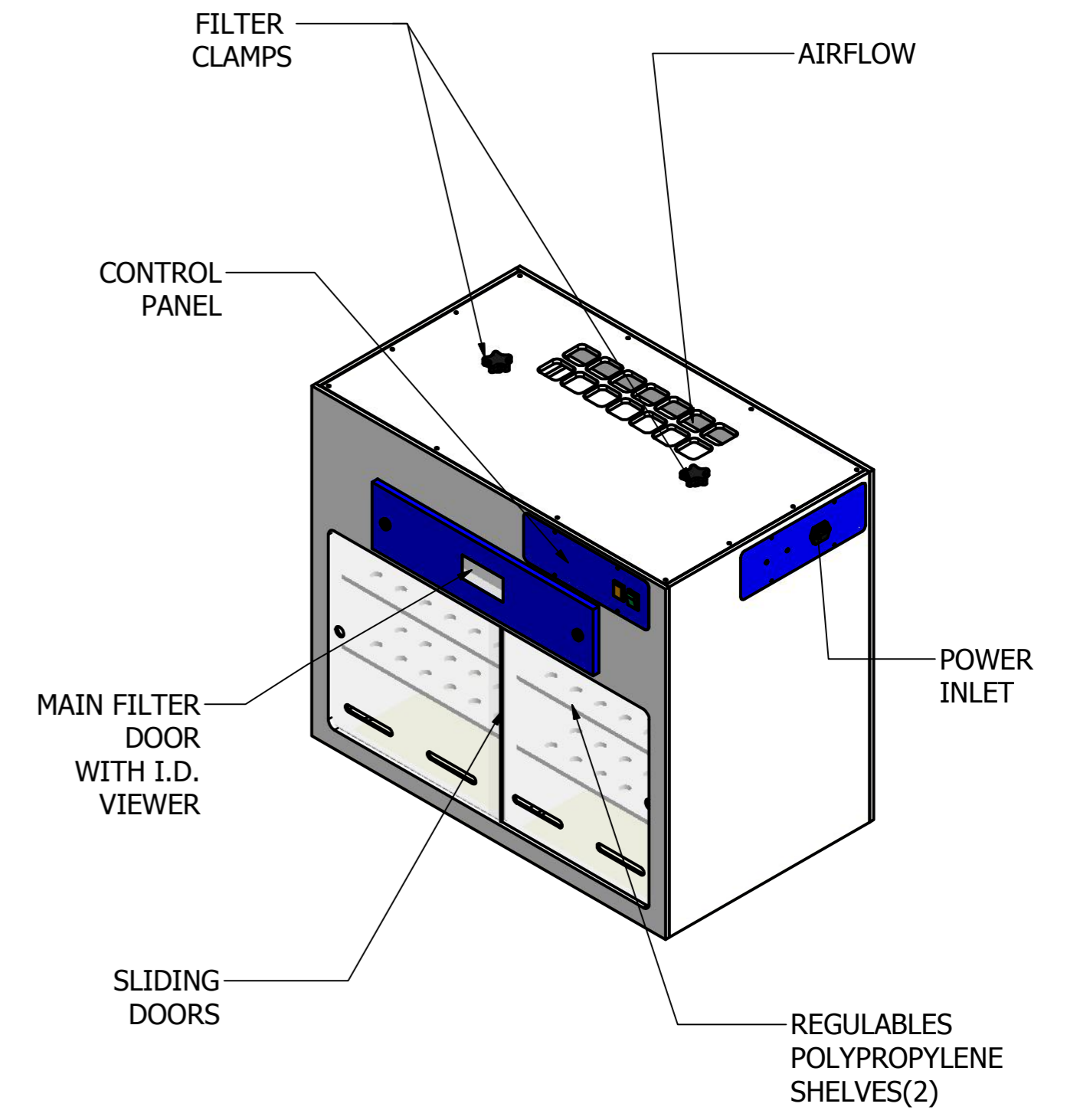
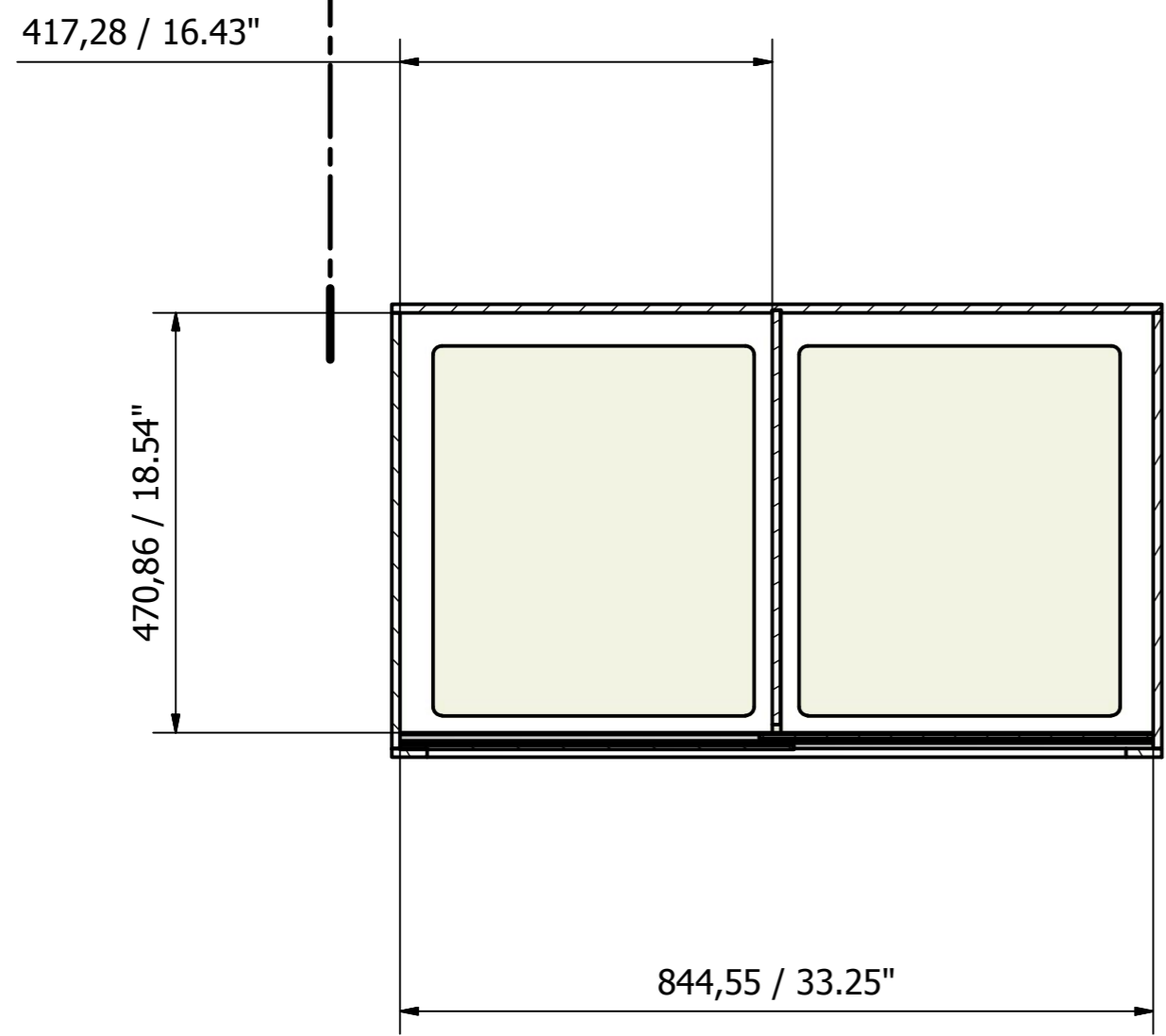
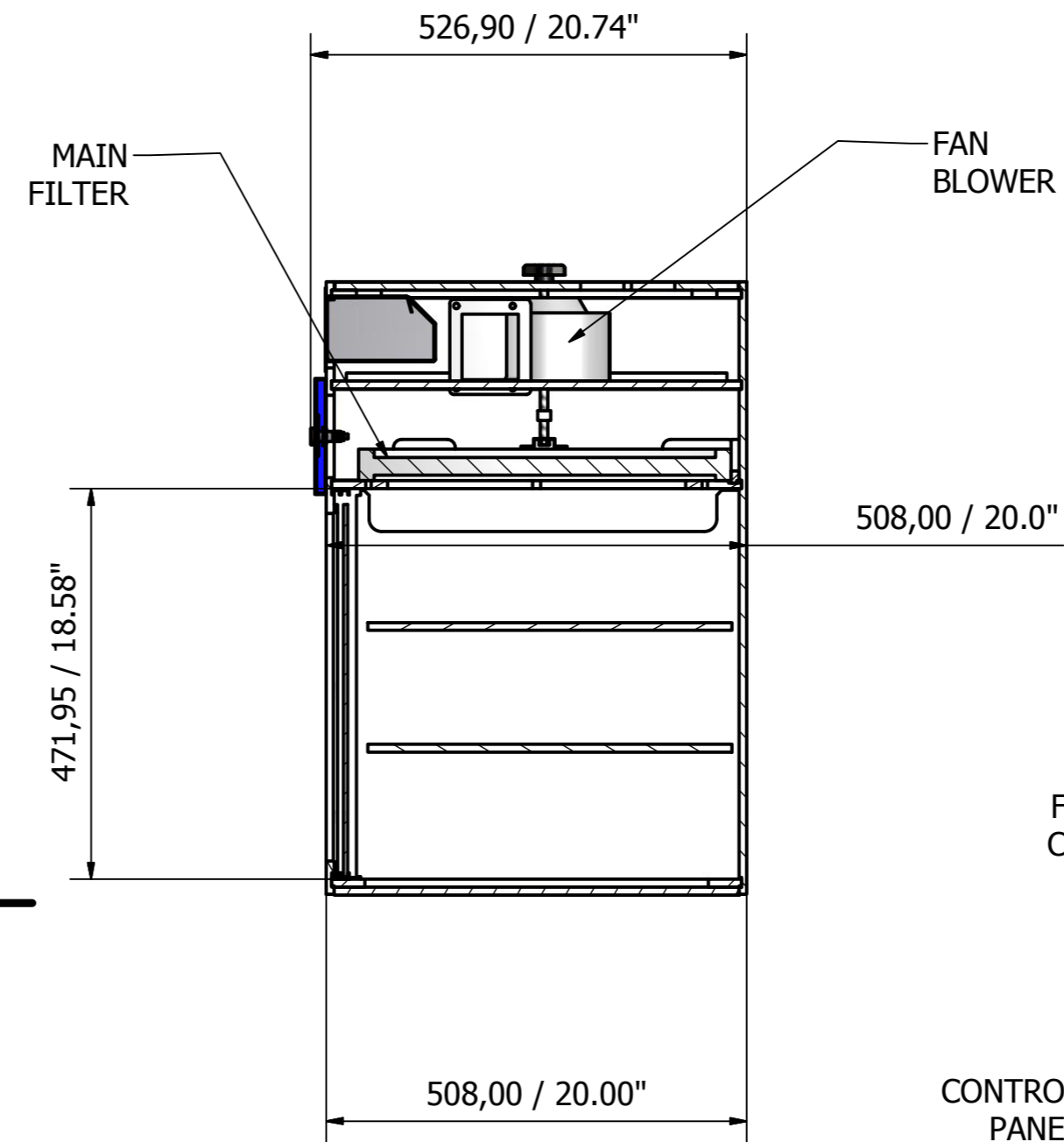
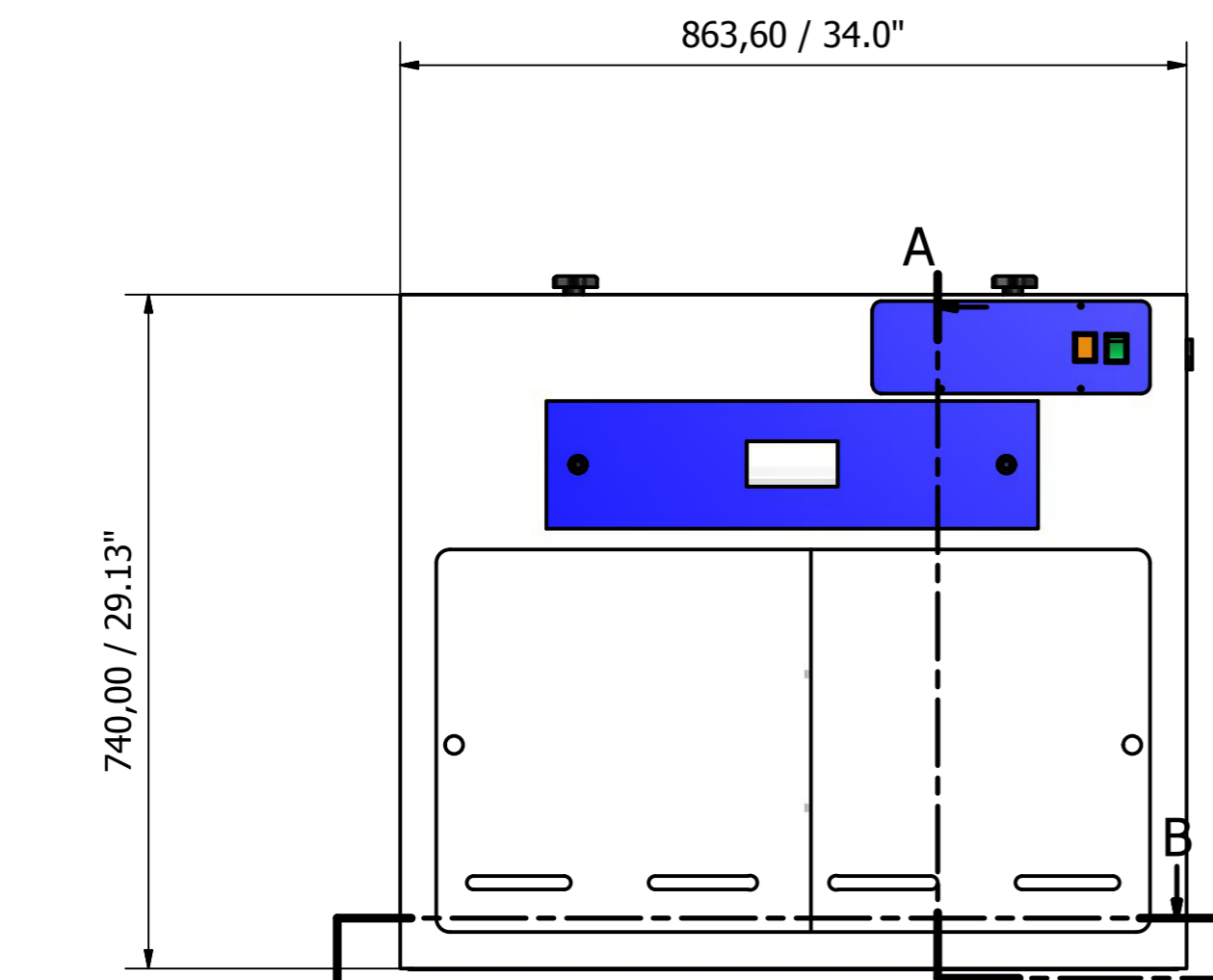

A-A (1 : 8)

B-B (1 : 8)

Designed by CG	Checked by	Approved by	Date 12/3/2013	Date
AIR SCIENCE USA		SAFESTORE 34S CABINET		
		SC34S-GAssem	Edition 3	Sheet 1 / 1