

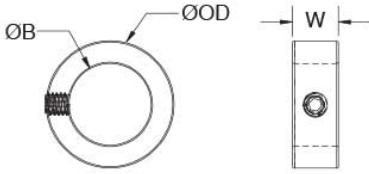

MSC-10-F

Ruland MSC-10-F, 10mm Set Screw Shaft Collar, Black Oxide Steel, 20mm OD, 10mm Width



Description

Ruland MSC-10-F is a set screw shaft collar with a 10mm bore, 20mm OD, and 10mm width. It is commonly used for guiding, spacing, stopping, and component alignment in light duty applications where the collar is infrequently repositioned or removed. Holding power is derived from the screw as it is tightened onto the shaft. In order for the collar to obtain maximum holding power the shaft must be softer than the material of the screw. Proprietary processes have been developed by Ruland to maintain superior fit, finish, and holding power. MSC-10-F is stamped with the Ruland name and bore size for ease of identification. The forged screw tests beyond DIN 912 12.9 standards to ensure maximum holding power. MSC-10-F is manufactured from solid bar stock sourced from select North American mills and machined to a fine burr free finish. Ruland uses 1215 lead-free steel with a proprietary black oxide finish that produces a fine glossy finish while increasing holding power and resisting corrosion. MSC-10-F is RoHS3 and REACH compliant and manufactured in our Marlborough, MA factory under strict controls using proprietary processes.

Product Specifications

Bore (B)	10 mm	Width (W)	10 mm
Outer Diameter (OD)	20 mm	Width Tolerance	+0.076 mm / -0.254 mm
Bore Tolerance	+0.050 mm / +0.012 mm	Recommended Shaft Tolerance	+0.000 mm / -0.013 mm
Forged Set Screw	M5 x 5	Screw Material	Alloy Steel
Hex Wrench Size	2.5 mm	Screw Finish	Black Oxide
Seating Torque	4 Nm	Number of Screws	1 ea
Material Specification	1215 Carbon Steel Bar	Finish Specification	Hot Process Black Oxide, Impregnated with Naphthenic Oil, Centrifugally Dried
Temperature	-40°F to 350°F (-40°C to 176°C)	Country of Origin	USA
Manufacturer	Ruland Manufacturing	Weight (lbs)	0.039200
Tariff Code	8483.60.8000	UPC	634529014806
Note 1	This product has been discontinued as a standard item. Please inquire for special pricing.		
Note 2	Performance ratings are for guidance only. The user must determine suitability for a particular application.		
Prop 65	⚠️ WARNING This product can expose you to the chemical Ethylene Thiourea, known to the State of California to cause cancer and birth defects or other reproductive harm. For more information go to www.P65Warnings.ca.gov .		

Installation Instructions

1. Use the MSC-10-F set screw shaft collar as it is received.
2. Wipe the bore clean.
3. Apply a thin coat of light oil to the shaft.
4. Place the collar onto the desired shaft location and tighten it using a 2.5 mm hex wrench until a slight resistance is felt.
5. Wring collar into its final position and tighten the screw to the full recommended seating torque of 4 Nm using a 2.5 mm torque wrench.